



Il sistema Blow Up prevede un rosone, montato in corrispondenza del punto luce, dal quale si diramano i cavi a treccina che alimenteranno e terranno sospesi i corpi illuminanti.

Il rosone, di cui esistono più versioni, può essere montato sia a parete che a plafone.

I corpi illuminanti LED sono disponibili in numerosi modelli con differenti forme, finiture, e tipo di luce prodotta e sono alimentati a tensione di rete.

BLOW UP

design Pepe Tanzi, 2019

The Blow Up system consists of a rose, installed on the existing lighting point (power connection), from which the XL lighting bodies branch out and are suspended by means of their power cables.

The rose is available in different sizes and may be mounted on walls or ceilings. The lighting bodies are available in several models. They come in different shapes, finishes, type of light emitted and are powered by mains voltage.

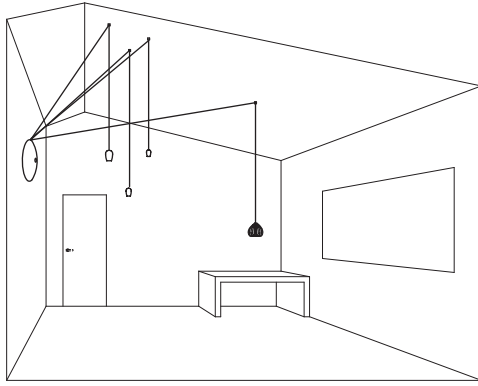



LAMPADINE LED 220V

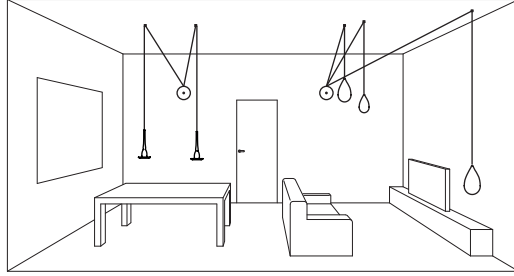



LAMPADINE LED 220V

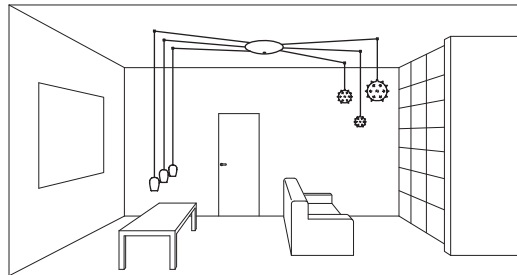



LAMPADINE LED 220V

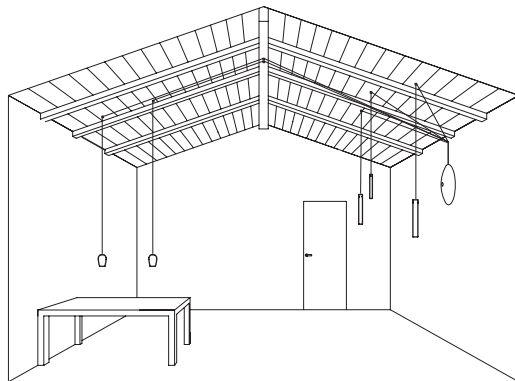



LAMPADINE LED 220V

1.

Scegli la zona che vuoi illuminare

Choose the area you wish to light

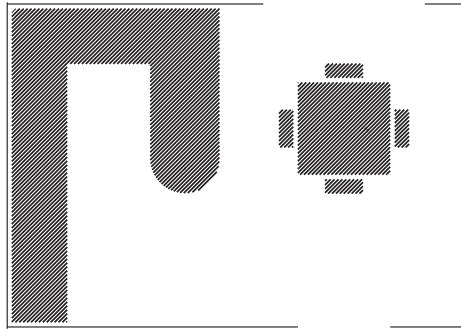

2.

Individua il punto luce a cui collegare il rosone

Locate the power supply to which you will connect the rose

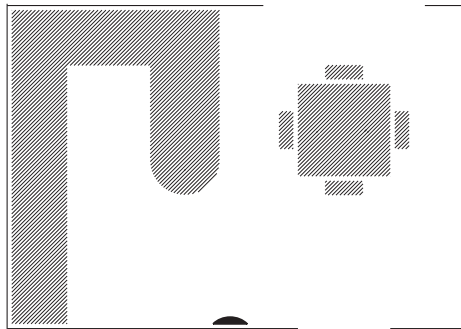

3.

Scegli e posiziona a tuo piacere i corpi illuminanti

Choose and place the lighting bodies

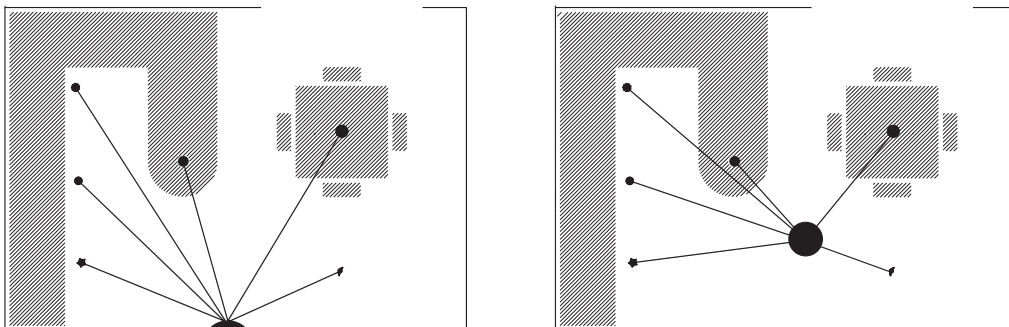



LAMPADINE LED 220V